



# In-Kone® TECHNICAL SHEET

## Chapter 1 : Instrumentation

### Screw-retained guided implant holder ULTIMATE G42 - In-Kone® ST platform system



ZI de Sacuny  
118 Avenue Marcel Mérieux, 69530 BRIGNAIS, FRANCE  
Tel : 04 78 56 97 00 – Fax : 04 78 56 01 63  
www.globald.com

This document is intended for dental surgeons.  
It describes the characteristics and protocols for using  
the G42 guided surgery implant holder on the In-Kone®  
ST platform system.

## G42 implant holder - Description & indication

The **In-Kone® ST G42 screw-retained implant holder** (Ref. DPVIKST-G42) is an alternative for the placement of In-Kone ST platform implants (diameters 3.5 and 4 mm) to G42 contra-angle implant driver (Ref. DCPICAIKST-G42 and DCPICAIKST-G42L) in guided surgery with the ULTIMATE G42 kit. They will be particularly used in complex cases of full arches, notably during the OLYMP protocol (see documentation: OLYMP Protocol - Guided multi-stage surgery for immediate loading).

This implant holder consists of 2 parts: the body of the implant holder and a "captive" or "unlosable" screw, which makes it easier to use in the mouth. This type of screw is similar to that of the direct implant pick-up transfers; it is not necessary to completely unscrew it from the body of the transfer in order to disengage the entire implant, which then facilitates the disinsertion of the transfer or, as here, the implant holder. Of course, this screw will be completely unscrewed from the body for cleaning and sterilization operations.

## Equipment required

### Hexagonal screwdriver

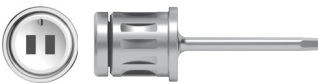

DCM1.2 (C/ L)

### Torque wrench\*



DCDYN-70D

### Ratchet adapter



Ref 518-1000274

### Optional instruments

#### Molt Stripper



#### WD platform In-Kone® extractors



DEMWD (Available in standard,  
long & extra-long version)

### Implant holder\*



DPVIKST-G42

*WD platform In-Kone® instrumentation is laser marked with  
a black ring and/or WD for easy identification.*

## Placement of the implant holder on the implant

Outside the mouth, it is necessary to place the In-Kone® ST G42 screw-retained implant holder (Ref. DPVIKST-G42) on the implant, which is positioned in its tube. A simple manual screwing may be sufficient and finalized using the usual DCM1.2 hexagonal screwdriver, applying a torque of 15 N.cm. The implant will be placed in the mouth using the guided surgery adapter (Ref. 518-1000274) and the torque wrench. Take care not to exceed a torque of 70 N.cm.



1. Position the implant holder on the implant, firmly engage the hexagonal index in the implant connection. Tighten the implant holder screw using a DCM1.2 screwdriver and **apply a tightening torque of 15 N.cm with the help of the torque wrench.**

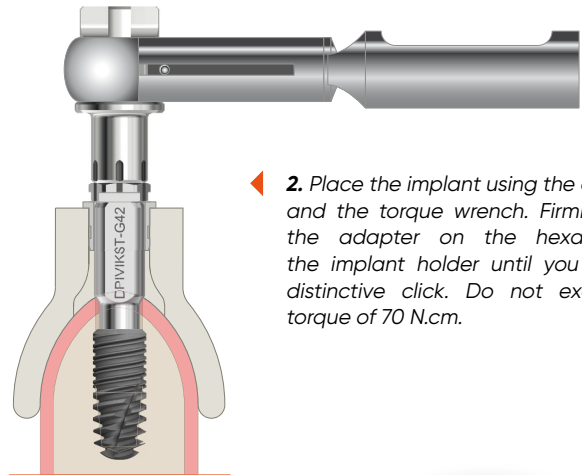

2. Place the implant using the adapter and the torque wrench. Firmly place the adapter on the hexagon of the implant holder until you hear a distinctive click. Do not exceed a torque of 70 N.cm.

3. Make sure to stop the implant placement once the drill stop is in contact with the sleeve as shown in the image. Engraving reminders are present on the implant holder and the adapter to position an hexagonal section in the vestibule if necessary.

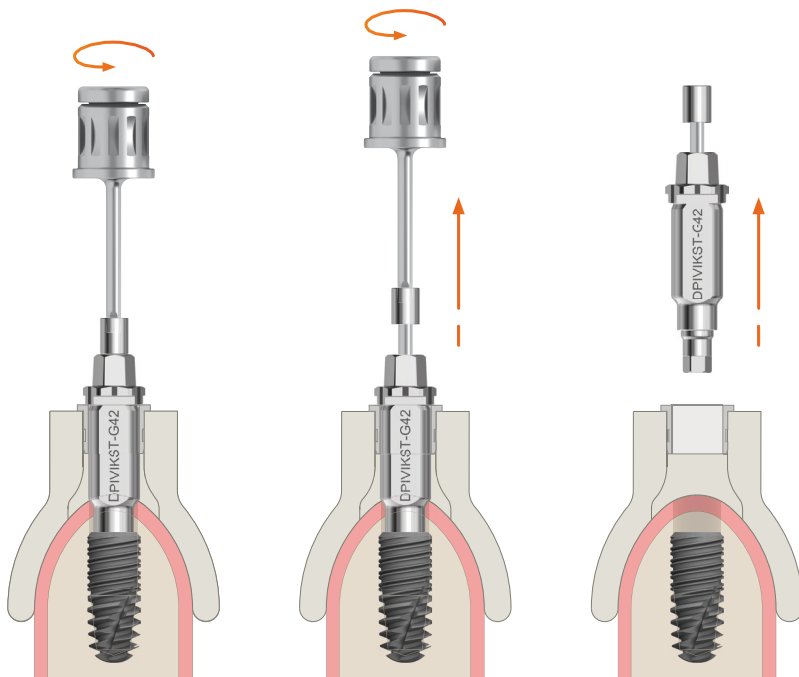
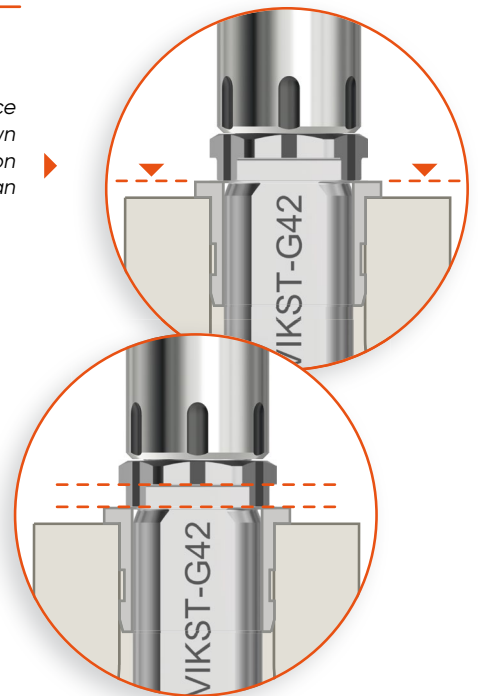

4. Unscrew the screw from the implant holder, once it is disengaged from the implant without removing it completely, remove the implant holder.

### 5. Optional:

There are several options for removing the implant holder in case it becomes stuck in the implant and/or the sleeve:

- A Molt stripper can also be placed in the free locations provided in the implant holder stop, as shown **in the figure above** in order to make slight movements to remove the slight jamming.
- Remove the screw completely from the implant holder and use the WD abutment extractor

\* The DCDYN-2 torque wrench is a Class I medical device manufactured by Josef Ganter Feinmechanik GmbH. The implant holder is a Class I medical device manufactured by Antea. Please read the instruction leaflets before use.

Our instructions for use are digital. Please refer to the QR code and the URL link shown on the device label. The leaflets are nevertheless available on request and without additional charge within 7 days. The request must be sent to the following address: [quality@globald.com](mailto:quality@globald.com)